

Freezer & Fridge door Alarm



Let's protect the planet !

FREEZER AND FRIDGE DOOR ALARM.

Please read the instructions carefully, and **clean** the fridge surface before use. The blinking red **LED** will help you find the appropriate **gap**. Packaging List :

1. *User Manual x1*
2. *Fridge/Freezer Alarm + Magnetic Sensor.*
3. *3M tape : 2x Big Sticker + 2x Small Sticker*

A) Technical parameters:

Working humidity	< 90%
Working temperature	-10 ~ 50°C
Decibel Level	80 to 110 dB
Batteries	LR44 X3 (<i>Replaceables</i>)
Standby current	≤ 6uAh
Induction distance	0.5~1inch (1.2~2.5cm) *
Standby time	About 1 Year

* *The Red **LED** will help you get the appropriate distance:
NB : A max gap of **0.6 inch** is permitted on **Steel** surfaces.*

B) Installation Video:

Download any QR App
and scan this code or
visite online video at :
www.Fridggi.com/install



C) Installation Steps:

STEP 1 :

- a) Pull the safety tab 
- b) Move the mini black switch to ON
(you get one Beep).
- c) Put the sensor near Fridggi.



STEP 2 :

When the sensor is pushed away (= Door Open) the **Red LED** will start blinking, and Fridggi emits a low Beep on the Max gap (0.5~1inch).

(No Beep on modes Quiet/Medium)



STEP 3 : Clean the surface, then **Stick** the mini Sensor on the door, select a placement (front, left, or top) where you can put the sensor and Fridggi on the same level.

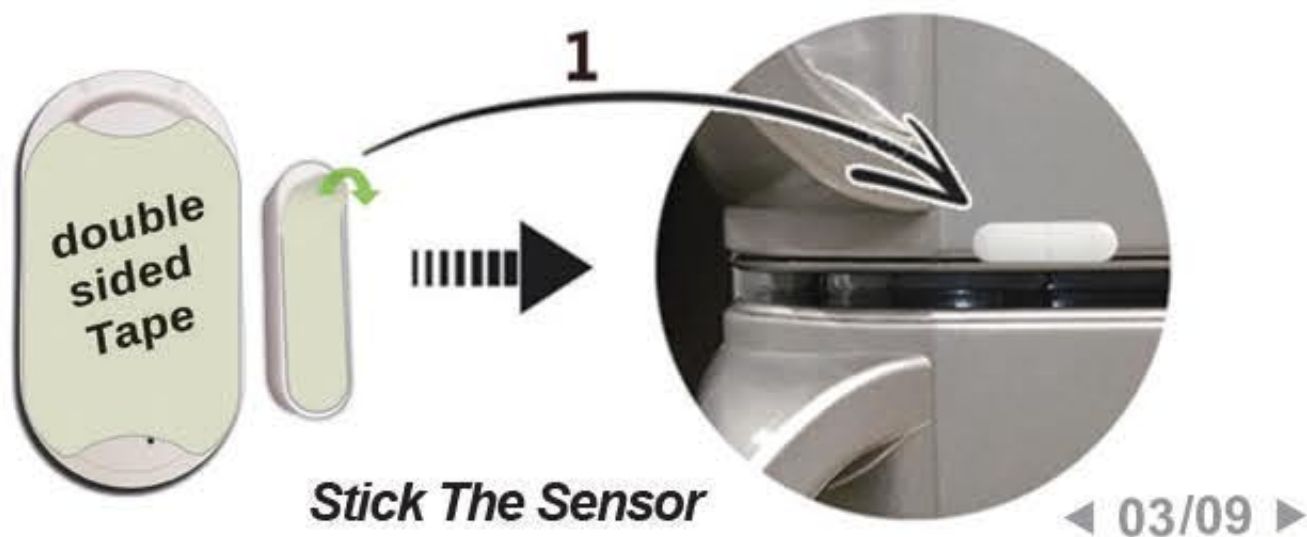

STEP 4 :

Mode Normal is set by default; it emits a low beep when the door is opened, and the **Red LED** starts blinking :

- a) Put the Alarm on the fridge or freezer body, **try** 0.5~1in distance from the sensor (1.2~2.5cm).
- b) Open/close the door several times, and check if you get a beep and the **LED** blinks each time you open it.
- c) Mark the position with a marker pen.
- d) **Clean** the surface, **Peel** Tape and stick *(Dry after 5min)*.



D) Functions:

Open the door and you will see the **Red LED** blinking for **12 seconds** then wait for :

- a)** 1 minute; one DI DI alert.
- b)** 2 minutes; two DI DI alerts.
- c)** 3 minutes; continuous alerts for 1 minute.
- d)** 4 minutes; 105 dB Siren (stay 20 seconds) replay every 4 minutes. (*mode Normal & Loud only*)

E) Multi-purpose:

1) Monitor two Doors:



2) Monitor one Door:

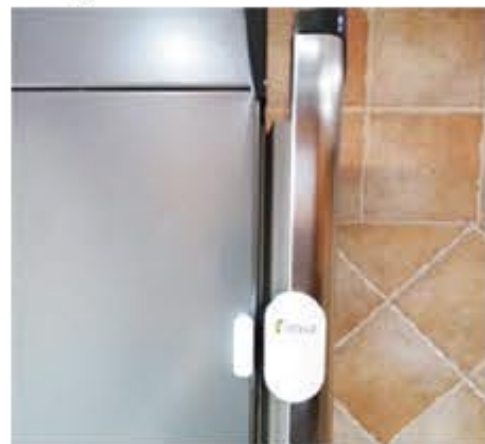

F) Volume Levels:

Short press **SET** button, and wait for Beep confirmation:

- a) **Quiet** (1 Beep): **No** Beep every 10s, 80 d
Di Di after 1,2 and 3 minutes.
- b) **Medium** (2 Beeps): **No** Beep every 10s,
85 dB Di Di after 1,2 and 3 minutes.
- c) **Normal** (3 Beeps): Low Beep every 10s,
95 dB Di Di after 1,2 and 3 minutes then **105 dB** every
4 minutes (set by default).
- d) **Loud** (4 Beeps): a Beep every 10s, **105 dB** Siren after
1 min (for 2 sec), 2 min (for 4 sec) and 3 min(for 30 sec)
+ **Replay** every 4 minutes (for 20 sec).



*Loud mode is suitable for freezers and fridges
located in the basement or garage.*

** Allow +/- 5dB difference on sound levels.*

G) Frequently asked questions :

What happens if I miss 1, 2, and 3-minute alarms?

Normal and Loud modes include a 20-second siren. (105 dB) that replay every 4 minutes.

It worked when I put it on the fridge, but now it's not?

Turn **off/on** the mini switch; if you get a **beep**, it may come from the **gap** between the alarm and the sensor, please remove the alarm, then push it by 0.1 inch near the sensor and stick it with a new double-sided tape.

What if the door is only slightly open?

The red **LED** blinks on the max gap; move the Alarm until you get the suitable distance (The LED **Stop**), open the door to check if the red LED **blinks** again, then peel and stick.

How do I stop Fridggi from beeping every 10 seconds ?

You need to change **mode**, short press **SET** button; 1 beep confirmation (Quiet Mode) or 2 beeps (Medium Mode).

H) Batteries:

The 3x LR44 can last up to 1 year and must be changed when the **loud mode** stops working (low power) or when the alarm emits a continuous **Du Du Du...**(dead batteries);

- 1) Use Eye protection before changing batteries.
- 2) Remove the mini Screw.
- 3) Slide Up gently the front cover, and remember the + and - position (take a picture).
- 4) Remove the 3x LR44 batteries, start with the one in the middle, and use 3 new LR44 or AG13.
- 5) Slide down the cover and restore the Screw.



FRIDGGI

For any technical issues , contact us by email :
support@fridggi.com.

WARNING

- **INGESTION HAZARD:** This product contains a button cell battery.
- **DEATH** or serious injury can occur if ingested.
- A swallowed button cell or coin battery can cause **Internal Chemical Burns** in as little as **2 hours**.
- **KEEP** new and used batteries **OUT OF REACH** of **CHILDREN**
- **Seek immediate medical attention** if a battery is suspected to be swallowed or inserted inside any part of the body.



- + Remove and immediately recycle or dispose of used batteries according to local regulations and keep away from children. Do NOT dispose of batteries in household trash or incinerate.
- + Even used batteries may cause severe injury or death.
- + Call a local poison control center for treatment information
- + Battery voltage 1.5V LR44 or AG13, Alkaline.
- + Non-rechargeable batteries are not to be recharged.
- + Do not force discharge, recharge, disassemble, heat above 60°C or incinerate. Doing so may result in injury due to venting, leakage or explosion resulting in chemical burns.
- + Ensure the batteries are installed correctly according to polarity (+ and -).
- + Do not mix old and new batteries, different brands or types of batteries, such as alkaline, carbon-zinc, or rechargeable batteries.

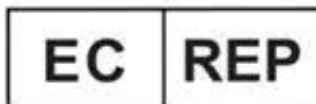

Clever Rep AB
Box 1898, 116 74, Stockholm
ar-contact@cleverrepresentative.eu

